

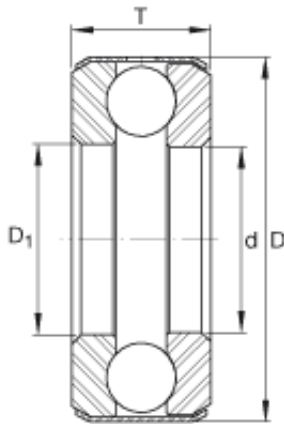

## Bearing Rolamentos do Brasil Ltda.



### 012.45.1600 Slewing Bearing

Bearing No. D21

Size	44.45x78.588x20.65 mm
Bore Diameter	44,45 mm
Outer Diameter	78,588 mm
Width	20,65 mm
d	1 3/4 inch
d	44,45 mm
D	3,094 inch
D	78,588 mm
T	0,813 inch
T	20,65 mm
D <sub>1</sub>	1,781 inch
m	0,9 lbs / Weight
m	406 g / Weight
C <sub>a</sub>	10600 lbf / Dynamic load rating (axial)
C <sub>a</sub>	47000 N / Dynamic load rating (axial)
C <sub>0a</sub>	26500 lbf / Static load rating (axial)
C <sub>0a</sub>	118000 N / Static load rating (axial)
Category	Thrust Ball Bearing
Inventory	0.0
Manufacturer Name	SCHAEFFLER GROUP
Minimum Buy Quantity	N/A
Weight / Kilogram	0.406
EAN	4012802034509

D21 Bearing 2D drawings and 3D CAD models



## Bearing Rolamentos do Brasil Ltda.

Product Group	B00308
Rolling Element	Ball Bearing
Thrust Bearing	Yes
Single or Double Direction	Single Direction
Banded	Yes
Cage Material	Steel
Precision Class	ABEC 1   ISO P0
Component Description	Roller Assembly Plus Raceways
Other Features	Single Row
Long Description	1-3/4" Bore 1; 1-25/32" Bore 2; 3-3/32" Outside Diameter; 13/16" Height; Ball Bearing; Single Direction; Banded; Steel Cage; ABEC 1   ISO P0 Precision
Inch - Metric	Inch
Category	Thrust Ball Bearings
UNSPSC	31171552
Harmonized Tariff Code	8482.10.50.08
Noun	Bearing
Keyword String	Ball Thrust
Manufacturer URL	<a href="http://www.ina.com">http://www.ina.com</a>
Weight / LBS	0.887
Bore 1	1.75 Inch   44.45 Millimeter
Outside Diameter	3.094 Inch   78.588 Millimeter
Overall Height with Aligning Washer	0 Inch   0 Millimeter
Bore 2	1.781 Inch   45.237 Millimeter
Height	0.813 Inch   20.65 Millimeter